

## RunCam 3S

### User Manual

#### Instruction Diagram

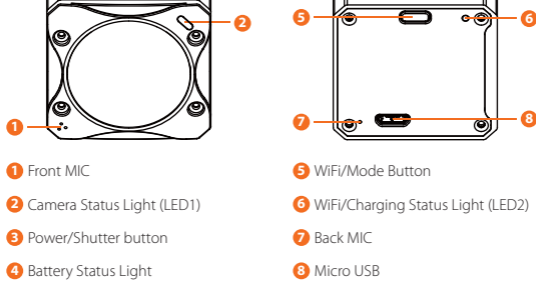

- 1 Front MIC
- 2 Camera Status Light (LED1)
- 3 Power/Shutter button
- 4 Battery Status Light
- 5 WiFi/Mode Button
- 6 WiFi/Charging Status Light (LED2)
- 7 Back MIC
- 8 Micro USB

#### Charging

Micro-USB supports DC 5-15V power supply. A DC 5V1~2A charger is recommended. The charging status light (red) will turn on during charging and turn off when charging is complete. It takes about 2 hours to get fully charged.

#### Battery Status

● ● ●	● ●	●	Blink ●
>66%	<66%	>33%	<10%

#### Basic Camera Operation

<b>Powering On/Off</b>	• Long press the Power/Shutter button
<b>WiFi On/Off</b>	• Short press the WiFi/Mode button If the WiFi/ Charging Status Light (LED2) <b>blinks blue</b> , it means it is ready to be connected and it will stop blinking and become <b>constantly on</b> after being connected. Default SSID: RC3S_***** (* for letters or numbers) Default WiFi password: 1234567890
<b>Mode Switching</b>	• After powering on, long press the WiFi/Mode button to cycle among the three modes: Video/Photo/OSD setting.
<b>Video Mode</b>	Camera Status Light (LED1): <b>Red</b> • Press the Power/Shutter button to start/stop recording.
<b>Photo Mode</b>	Camera Status Light (LED1): <b>Green</b> • Press the Power/Shutter button to capture photos.
<b>OSD Setting Mode</b>	Camera Status Light (LED1): <b>Orange</b> • Press the Power/Shutter button to browse. • Press the WiFi/Mode button to select. • Long press the WiFi/Mode button to exit the current menu.
<b>Forced Shutdown</b>	• Simultaneously press the Power/Shutter button and WiFi/Mode button.
<b>Reset</b>	• In standby mode, press the WiFi/Mode button three times in rapid succession. The camera status light (orange) blinks twice. The camera completes its resetting and then automatically shuts down.

#### microSD card

Insert the microSD card as indicated by the icon next to the card slot. Use brand name memory cards (sold separately) that meet these requirements:

- microSD, microSDHC, or microSDXC
- Class 10/UHS-I/UHS-II/UHS-III
- Capacity up to 64GB

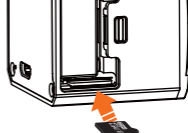

**NOTICE:** Use care when handling memory cards. Avoid liquids, dust, and debris. As a precaution, power off the camera before inserting or removing the card. Check manufacturer guidelines regarding use in acceptable temperature ranges.

#### Connection to computer

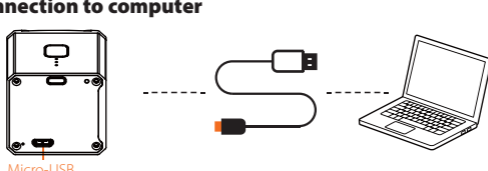

After turning on the RunCam 3S, connect it to the computer via USB cable, then it will be recognized as a removable disc.

**NOTICE:** If the camera can not be recognized by the computer after connecting, please make sure that a microSD card is well inserted. If the information on microSD card can not be read normally, please try with another micro USB cable or USB port on the computer.

#### App

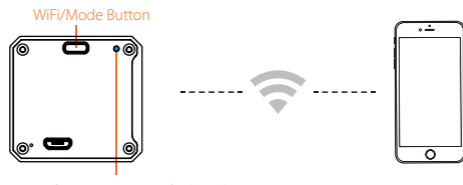

1. After powering on, press the WiFi/Mode button, the WiFi status lights (blue) blink when the WiFi is on and ready to connect.

2. In the wireless network settings of your smartphone, find the SSID connection of the RunCam 3S and enter the password. After the successful connection, the WiFi status lights (blue) will be constantly on.

**NOTICE:** If using under low light, you can increase exposure in camera menu via APP to improve the image quality and vice versa, decreasing it to avoid overexposure.

**Android and iOS APP:** Search 'RunCam App' on Google Play/App Store, or download on our website: <https://runcam.com/download/runcam3s>

#### Firmware upgrade

Firmware Upgrade (orange lights blink)  
Ensure that the RunCam 3S battery is more than 50% before the upgrade.

##### Method 1 (recommended):

Connect your camera to your smartphone/tablet. If an update is available, the App provides instructions for installing it.

##### Method 2:

Manually copy the firmware file (RC3S.BRN) onto the microSD card. Follow the instruction on <https://runcam.com/download/runcam3s>.

To get the latest features and best performance from your RunCam 3S, make sure you are using the most current camera software. You can update your firmware with the RunCam App or at <https://runcam.com/download/runcam3s>.

#### OSD Settings (TV-OUT)

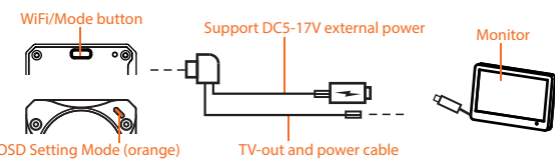

After powering on, long press the WiFi/Mode button until the camera status lights become orange. The camera is now in the OSD setup mode.

In the OSD setup mode, use the provided "USB Video Power Cable" to connect the camera to a monitor, settings on the screen.

#### Parameter

Video Resolution	1080p@60fps/1080p@50fps/1080p@30fps/720p@60fps
Video File Format	MOV
Image Resolution	2MP
AV Output Format	NTSC/PAL
Communication Interface	Micro USB
microSD card supported	64G max
Battery Capacity	850mAh
USB Power Input	DC 5-15V
Power Consumption	620mA @5V
Dimension	40*38*36mm
Net Weight	65g (with battery)

#### Check Complete User Manual

Please visit: <https://runcam.com/download/runcam3s>

#### Technical Support

Please visit: <https://support.runcam.com>